



1 BC-North Section/Elevation through Courtyard
1: 200



2 BC-South Section/Elevation through Courtyard
1: 200



3 BC-West Section/Elevation through Courtyard
1: 200

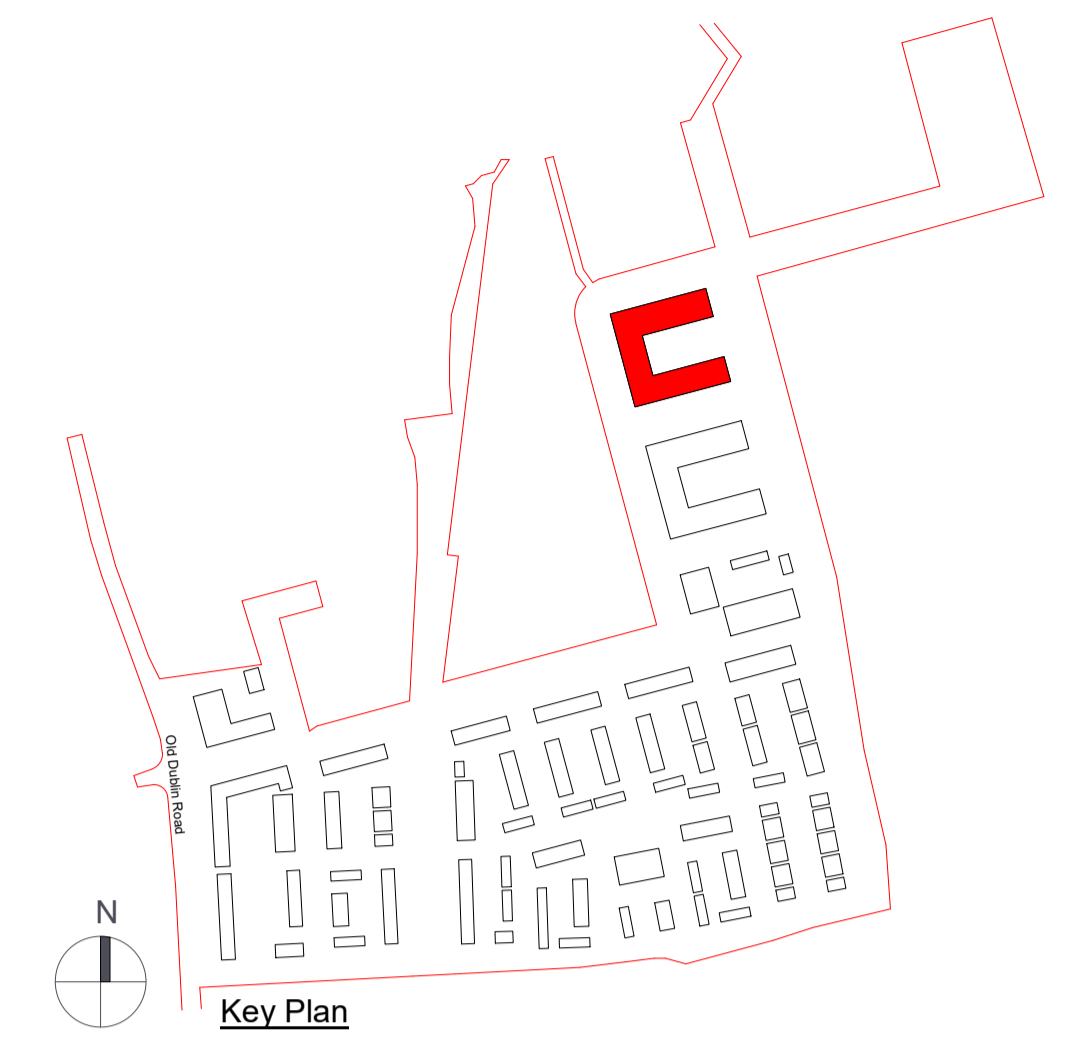

- 1 Brick Type A
- 2 Brick Type B
- 3 Brick Type C
- 4 Pre-Cast Frame Type A
- 5 Pre-Cast Frame Type B
- 6 Selected Render
- 7 Selected Contrasting Render
- 8 Metal Balustrade
- 9 Double Glazed Window System with Spandrel Panel
- 10 Selected Sedum Roof
- 11 Selected Metal Ventilation Grille

All levels (in meters) are related to Malin head datum.
All dimensions in millimeters.
Figured dimensions only are to be taken from this drawing.

Revision Description	Date	Rev. No.	Issued by
Issued for Planning	09.10.2019	1	TT

Figured dimensions only to be used. This drawing is copyright of O'Mahony Pike Architects Ltd. All information is shared as per approved use in accordance with BS1192(2007) + A2(2016), Table 5; Standard Codes for Suitability of Models and Documents. If the 'Status' field is empty, this information has been shared at S0 - WIP.

omahony pike Project No.: 1618 Scale @ A1: 1 : 200
 email: info@omahonypike.com Project Lead: SD Date Printed: 09.10.2019
 tel: +353 1 202 7400 Dublin Cork
 fax: +353 1 283 0822 The Chapel 26 South Mall
 www.omahonypike.com Mount St. Anne's Cork City
Milltown, Dublin 6 Co. Cork
D06 XN52 Ireland T12 R2RV Ireland

Model No.: 1618-OMP-00-M3-A-0001 Current Rev.: 1 Status: S0
 Purpose: Planning

Project: Woodbrook Phase 1
 Location: Woodbrook
 Client: Aeval

Drawing Title: Block C - Courtyard Elevations and Sections
 Drawing No.: 1618-OMP-BC-ZZ-DR-A-21003